

SAMSUNG SHS-2320 QUICK GUIDE

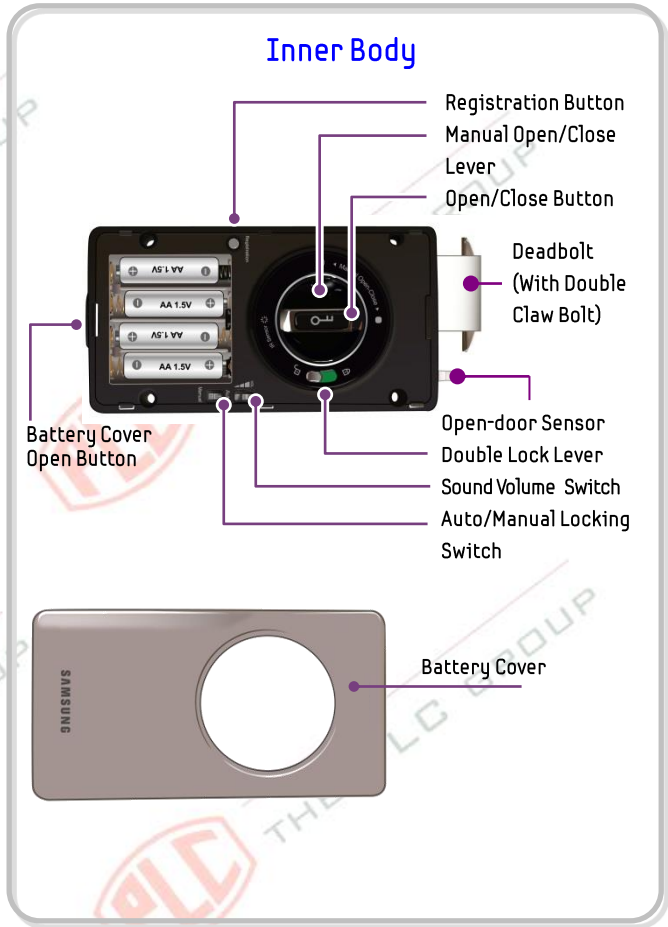

No.	Name	Description
1	9V Emergency Power Port	Power can be supplied from the emergency battery after the main batteries have been completely discharged (9V alkaline battery).
2	RF Card Reader	The RF card reader will operate properly when a key tag and a RF card are placed within 20mm and within 10mm of the card reader. The recognition distance may differ depending on the card manufacturer.
3	Battery	Although actual battery life differs depending on the manufacturer, date of production and operation environment, 4 x 1.5V AA alkaline batteries can last for ten months, based on an average of 10 uses per day. Liquid leaks from batteries can damage the product. Check/replace the batteries regularly (every 6 months). Don't mix the batteries of the different brand, because it will affect the lock performance.
4	User-friendly Graphic Interface	If reading of card completes, the door opens and ☺ icon will light up on the user-friendly graphic interface. If reading of card fails, ✕ icon will light up on the user-friendly graphic interface.
5	Manual Open/Close Lever	Lever used to lock or unlock the door manually in case of any electrical failure.
6	Auto/Manual Locking Switch	This switch is used to switch between automatic locking and manual locking. If it is set for automatic locking, the door is automatically locked when closed. If it is set for manual locking, the door is not automatically locked when closed.



1-Year Installation Warranty



2-Year Product Warranty



Samsung RF Warranty Card - PLC Warranty Services:

- Service Enquiries
- Key Duplication
- Cylinder Replacement Orders

DISCLAIMER: All information are subjected to change at anytime without prior notice by The PLC Group or its associated partners/suppliers. Should there be any variations in product functionality, outlook, technical specifications, documentation, service, warranty, promotions and/or pricing, the actual offering at the time of purchase shall be the confirmed version.

• The catalog informations for reference only. For updated details, please contact The PLC Group.
• In case of dispute, The PLC Group reserves the right to final decision.
• If there is any inconsistency of conflict between English and Chinese version, the English version shall prevail.

Samsung SMART Doorlock names and logos are registered trademarks and properties of SAMSUNG SDS CO. LTD., any use without prior written consent is prohibited. Copyright© 2015 All rights reserved.



30TH ANNIVERSARY
THE PLC GROUP

(EXCLUSIVE DISTRIBUTOR for Hong Kong & Macau 香港及澳門獨家總代理)
Head office: Unit A-D 9/F Gemstar Tower 23 Man Lok Street Hunghom Kowloon Hong Kong
辦公室: 香港九龍紅磡民樂街 23 號駿昇中心 9 樓 A-D 座

專業 超越 三十 載

客戶服務熱線 Customer Service Hotline: 2765 9667 傳真 Fax: 2330 2082 電郵 Email: plc@plc.com.hk 網址 Website: www.plc.com.hk

SAMSUNG SHS-2320 簡易功用說明

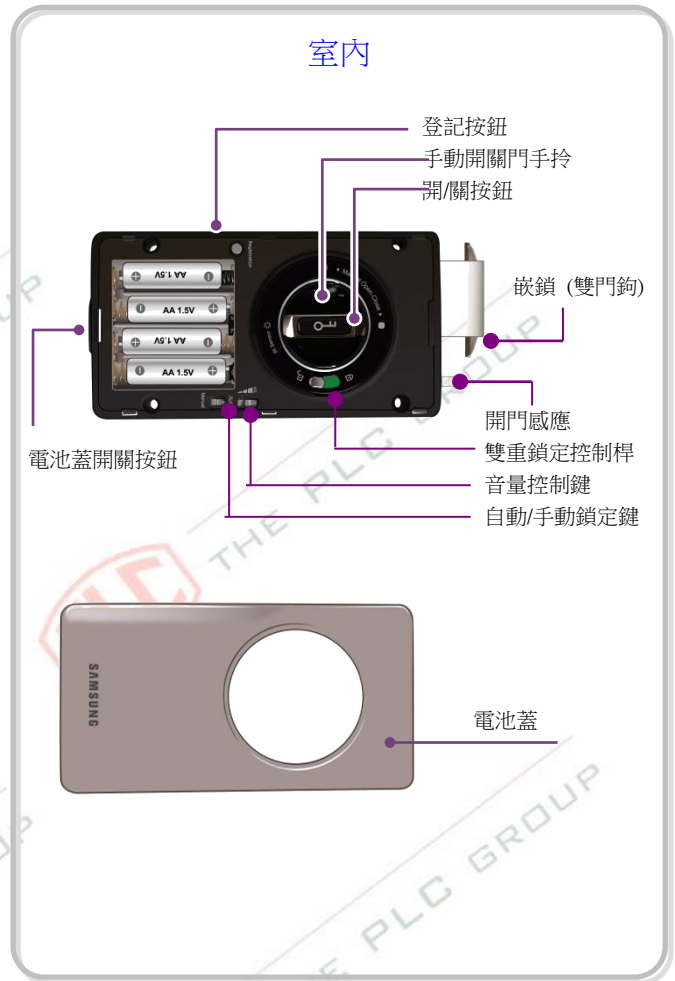

No.	名稱	功用說明
1	9V 緊急電源接口	當電池用完時，接入應急用電池，即可接通電源。(使用 9V 鹼性電池)
2	感應卡讀頭	持卡接近感應卡讀頭，迷你卡應保持在 20mm 以內，RF 卡應保持在 10mm 以內。不同制造商生產的電子卡的感應距離可能有所不同。
3	電池	電池因製造廠家、製造日期、使用環境不同，使用壽命會稍有差異。4 顆 1.5V AA 型鹼性電池，按 1 天使用 10 次為例，大約可用 12 個月。 為避免電池液體洩漏時會損壞鎖體，請務必定期 (約 6 個月間隔) 進行確認或更換。 請勿混合不同品牌的電池，混合不同品牌的電池會影響數碼電子門鎖性能。
4	門鎖狀態圖標顯示	如成功認證，門外鎖體會有 ☺ 狀態提示燈亮起。 如未能成功認證，門外鎖體會有 ✕ 狀態提示燈亮起。
5	手動開關門手柄	開關門手柄可用於開門及鎖門之用，即使當電子部份有問題時仍能正常使用。
6	自動/手動鎖定鍵	自動鎖門和手動鎖門轉換時使用的開關。 置於自動位置，關門即可自動上鎖；置於手動位置，關門也不會上鎖。



1 年安裝保養證



2 年產品保養證



SAMSUNG 原廠感應保養卡 - PLC 保養服務包括：

- 服務查詢
- 配匙服務
- 鎖膽更換服務

DISCLAIMER: All information are subjected to change at anytime without prior notice by The PLC Group or its associated partners/suppliers. Should there be any variations in product functionality, outlook, technical specifications, documentation, service, warranty, promotions and/or pricing, the actual offering at the time of purchase shall be the confirmed version.

- The catalog information is for reference only. For updated details, please contact The PLC Group.
- In case of dispute, The PLC Group reserves the right to final decision.
- If there is any inconsistency of conflict between English and Chinese version, the English version shall prevail.

Samsung SMART Doorlock names and logos are registered trademarks and properties of SAMSUNG SDS CO., LTD., any use without prior written consent is prohibited. Copyright© 2015 All rights reserved.



THE ANNIVERSARY (EXCLUSIVE DISTRIBUTOR for Hong Kong & Macau 香港及澳門獨家總代理)

THE PLC GROUP Head office: Unit A-D 9/F Gemstar Tower 23 Man Lok Street Hunghom Kowloon Hong Kong

辦公室：香港九龍紅磡民樂街 23 號駿昇中心 9 樓 A-D 座

專業 超越 三十 載 客戶服務熱線 Customer Service Hotline: 2765 9667 傳真 Fax: 2330 2082 電郵 Email: plc@plc.com.hk 網址 Website: www.plc.com.hk